

Fiscal Court Orders

COURT MET IN REGULAR SESSION, PRESENT COUNTY JUDGE-EXECUTIVE DEAN WATTS AND THE FOLLOWING NAMED MAGISTRATES: KEITH METCALFE, SAM HUTCHINS, BERNARD ICE, JEFF LEAR AND JERRY HAHN.

MINUTES APPROVED - JAN. 7

On motion of Sam Hutchins, second of Jerry Hahn, by unanimous vote of the Court, IT IS HEREBY ORDERED to approve the minutes of the Jan. 7 session of Nelson Fiscal Court as presented.

BILLS

On motion of Bernard Ice, second of Jeff Lear, by unanimous vote of the Court, IT IS HEREBY ORDERED to authorize the County Treasurer to pay the following bills:

**Nelson County Fiscal Court
Bills for Court Approval
January 21, 2014**

Name	Memo	Account	Amount
01 General Fund			
ADP	Payroll processing 010214	9100301 · Payroll Processing	\$ 36.95
Airgas Mid America	Welder supplies	5090427 · Maintenance - Supplies	83.58
American Tire	SO 43	5105479 · Law Enforc Tires	513.92
Aqua Treat	Monthly treatment	5415329 · Civic Center Maint Contracts	184.80
Code Administrators Assoc	Conference - Don. Logan	5115569 · Codes - Staff Training	170.00
Coulter's Towing	SO 45, 42	5105340 · Law Enforc Vehicle maintenance	80.00
Danville Office	Toner	5001445 · CJE Office supplies	103.49
Danville Office	Paper, printer ink	5040445 · Treasurer Office Supplies	78.96
Danville Office	Paper, fax cartridge	5115445 · Codes - Office Supplies	68.98
DC Communications LLC	New radios (2) for Explorers	5105723 · Law Enforcement Automobiles	1,337.00
Duplicator Sales & Service Inc	Monthly copy charges	5205445 · Animal Control Office supplies	13.25
Economy Pest Control	Portable toilet rental Jan 2014	5405348 · Recreation Program Support	70.00
Flaget Health Center	Random testing, employee medical	9400547 · Employee Medical/WC Claims	275.00
Hall, Thomas	Legal services	5310332 · Public Defender Contract	250.00
Hillyard	Receiptacle cans for cigarettes - 4	5081334 · Justice Center Bldg Maint	798.79
Houghlin Funeral Home	Coroner transports	5020308 · Coroner Autopsy & Services	800.00
KACo Leadership Institute	Metcalfe, Hutchins, Ice, Lear training	5025569 · Magistrates Conferences	325.00
Kleentech	Carpet cleaning service	5415329 · Civic Center Maint Contracts	190.00
KMCA	Winter training - Lear	5025569 · Magistrates Conferences	85.00
Ky Forestry	78780 acres fire protection	9500902 · Forest Fire Suppression	1,576.00
Leo Talbott & Son, Inc.	Chiller	5080329 · Old Courthouse Main Contracts	95.00
Leo Talbott & Son, Inc.	Replace AC Condenser	5085329 · Building Main Contracts	1,093.00
Leo Talbott & Son, Inc.	Health dept heat pump, cooling tower	5415742 · Civic Center	280.00
Patrons Home Center	Plumbing repairs	5080334 · Old Courthouse Bldg Maint	8.49
Patrons Home Center	Custodial supplies	5080411 · Old Courthouse Custodial Supply	172.22
Patrons Home Center	Bulbs, dumpster repairs	5081334 · Justice Center Bldg Maint	68.46
Patrons Home Center	Custodial supplies	5081411 · Justice Center Custodial Supply	372.18
Patrons Home Center	Dumpster area construction, shelving	5085334 · Sutherland Bldg Maint	79.31
Patrons Home Center	Custodial supplies	5085411 · Sutherland Bldg Custodial Suppl	172.21
Patrons Home Center	Chalk reel, driver bits, pipe fittings, supplies	5090427 · Maintenance - Supplies	53.60
Patrons Home Center	Bathroom repairs	5105334 · Law Enforcement Building Maint	13.78
Patrons Home Center	Keys for fire/range location	5105427 · Law Enforc Supplies	6.36
Patrons Home Center	Paint and supplies	5105571 · Law Enforc. Building Repairs	216.84
Patrons Home Center	Phone cord	5115445 · Codes - Office Supplies	8.29
Patrons Home Center	Keys	5135427 · EMA Supplies & Materials	7.80
Patrons Home Center	Custodial supplies	5305411 · Sr Citizens Custodial Supply	372.18
Patrons Home Center	Air filters - fairgrounds	5405348 · Recreation Program Support	25.97
Patrons Home Center	Custodial supplies	5415411 · Civic Center Custodial Supplies	172.21
Petty Cash - Codes	Certified mailings	5115463 · Codes - Postage	18.53
Quick Care Oil Lube Express	Dec 2013 vehicle maintenance	5105340 · Law Enforc Vehicle maintenance	2,147.15
Quill Corporation	Printer ink	5040445 · Treasurer Office Supplies	139.94
Sheriff	Sheriff Claims Oct Nov Dec 2013	5015199 · Sheriff Fees Payable	1,591.01
Simplex Grinnell	Semi-annual gas suppression systems test	5081329 · Justice Center Main Contracts	470.00
Speedway	Fuel	5105429 · Law Enforc Fuel	2,221.88
Springfield Laundry	Maats	5080411 · Old Courthouse Custodial Supply	43.00

Fiscal Court Orders

Jan. 21, 2014

Book 37

REGULAR SESSION OF NELSON FISCAL COURT

Page 164

Springfield Laundry
 Springfield Laundry
 Springfield Laundry
 Springfield Laundry
 Taser International
 Underwood, Judith A
 Walker Transmissions LLC
 Willett, Keith
 Young, Mark
 Total 01 General Fund

Mats
 Mats
 Mats
 Mats
 Taser Equipment
 Civic Center Cleaning 0114
 Transmission - Larry's truck
 Boot allowance
 Boot allowance

458.00
 93.00
 118.00
 23.00
 690.00
 850.00
 1,200.00
 75.00
 75.00
 20,472.13

02 Road Fund

Airgas Mid America
 American Tire
 Cintas
 Cintas
 Fisher Auto
 Flaget Health Center
 Keystops
 Kimball Midwest
 Kroger
 Lasco
 Lawson Products
 Limestone Farm Lawn
 Mackin's Wrecker
 Patrons Home Center
 Patrons Home Center
 Patrons Home Center
 Peterson Truck
 Safety Kleen
 Salt River
 Taylor Battery Co
 Total 02 Road Fund

Tank leases to 2019
 Shop tires
 Deodorizer
 Uniforms
 Parts for sign truck; wiper blades, vehicle bulbs
 Random testing
 Fuel
 Garage supplies
 Sugar, creamer
 Filters, tire sealant
 Drill bits, garage supplies
 Boom mower
 Truck 307
 Bulb
 Eye bolts, tape ruler, adhesive
 Masonry bits, gas can
 Truck 302
 Parts wash service
 Set poles - Nat Rogers/Vit.Ford; Spalding Hollow
 Battery

6105427 · Garage supplies
 6105479 · Tires
 6105427 · Garage supplies
 6105481 · Uniforms
 6105443 · Parts
 9400547 · Employee Medical/WC Claims
 6105429 · Fuel
 6105427 · Garage supplies
 6105427 · Garage supplies
 6105427 · Garage supplies
 6105427 · Garage supplies
 6105443 · Parts
 6105336 · Equipment repairs
 6103334 · Building Maintenance
 6105427 · Garage supplies
 6105443 · Parts
 6105443 · Parts
 6105427 · Garage supplies
 6105469 · Signs & Posts
 6105443 · Parts
 600.00
 157.65
 73.94
 1,241.40
 134.78
 120.00
 12,877.45
 163.92
 49.78
 213.49
 139.74
 121.12
 300.00
 12.99
 24.28
 23.02
 199.34
 159.40
 285.00
 106.51
 17,003.81

03 Jail Fund

Bob Barker
 Clems
 Coca Cola
 Dean Milk
 Etown Laundry
 Fed Ex
 Flowers Baking Co
 Flowers Baking Co
 Good Source Solutions
 Gordon Foods
 Gordon Foods
 Gordon Foods
 Gordon Foods
 Gordon Foods
 Gordon Foods
 IHS Pharmacy
 Jewish Physician Group
 KY Cavern Water
 Ky Standard
 Leo Talbott & Son, Inc.
 Maxima Supply
 Medica
 Nu Life Cartridge
 Nu Life Cartridge
 Patrons Home Center
 Robinson Textiles
 Robinson Textiles
 Robinson Textiles
 SE Emergency Physicians
 Securix
 Total 03 Jail Fund

Clothing inventory
 Food
 Inventory purchases
 Milk
 Sheets
 Freight - mattresses
 Bread
 Inventory
 Food
 Dishmachine lease
 Cleaning supplies
 Kitchen supplies
 Food
 Canteen purchases
 Testing supplies
 Inmate medical
 Inmate medical
 Water
 Newspaper subscription (2)
 AC, HVAC, freezer repairs
 Inventory purchases
 Inmate medical
 Paper
 Tags, markers
 Floor shine
 Mattress and covers
 Hygiene products
 Sandals
 Inmate medical
 Phone cards

5101428 · Canteen Inventory
 5101425 · Food
 5101428 · Canteen Inventory
 5101425 · Food
 5101437 · Linens
 5101437 · Linens
 5101425 · Food
 5101428 · Canteen Inventory
 5101425 · Food
 5101336 · Equipment Repairs
 5101411 · Custodial Supplies
 5101423 · Food Prep & Serving Supplies
 5101425 · Food
 5101428 · Canteen Inventory
 5101549 · Routine Medical
 5101549 · Routine Medical
 5101549 · Routine Medical
 5101445 · Office Supplies
 5101428 · Canteen Inventory
 5101329 · Building Main Contracts
 5101428 · Canteen Inventory
 5101549 · Routine Medical
 5101428 · Canteen Inventory
 5101445 · Office Supplies
 5101411 · Custodial Supplies
 5101437 · Linens
 5101453 · Prisoner Hygiene
 5101465 · Prisoner Clothing
 5101549 · Routine Medical
 5101428 · Canteen Inventory
 212.10
 2,004.47
 159.00
 1,673.00
 240.00
 104.50
 278.81
 180.48
 2,698.21
 85.00
 4,024.13
 570.74
 7,261.07
 432.42
 58.16
 557.65
 208.44
 69.93
 112.00
 1,236.36
 2,412.80
 195.73
 33.99
 135.45
 99.99
 1,131.40
 917.27
 165.00
 116.04
 616.00
 27,990.14

04 LGEA Fund

Cedar Creek Quarry LLC
 Total 04 LGEA Fund

Blanton Ford, Vititow Ford, Leonard Hall

6105409 · Rock
 2,067.99
 2,067.99

09 Ambulance Fund

3-D Graphics
 Airgas Mid America

5140481 · Staff Uniforms
 5140550 · Medical supplies & Materials

24.00
 173.85

Fiscal Court Orders

Jan. 21, 2014

REGULAR SESSION OF NELSON FISCAL COURT

Book 37
Page 165

American Tire	Sq 31 & 35	5140340 · Vehicle Maintenance & Repairs	378.50
American Tire	Sq 31 & 35	5140439 · Oil, lubes	196.13
American Tire	Sq 31	5140443 · Vehicle Parts	551.36
American Tire	Tire repair - 96 Crown Vic	5140479 · Tires	20.86
Bound Tree Medical	Medical supplies	5140550 · Medical supplies & Materials	158.47
Danville Office	Toner, printer ink, paper	5140445 · Office Supplies	266.45
Financial Forms & Supplies	Laser invoices	5140445 · Office Supplies	309.09
Flaget Health Center	Random testing, pre employment	9400547 · Employee Medical/WC Claims	95.00
Galls	Car 602	5140443 · Vehicle Parts	509.08
Galls	Uniforms	5140481 · Staff Uniforms	94.42
Gateway EDI LLC	Electronic claims	5140445 · Office Supplies	45.00
Mechanic Masters LLC	Sq 38	5140340 · Vehicle Maintenance & Repairs	70.00
Mohawk Medical	Medicine and supplies	5140550 · Medical supplies & Materials	451.37
Newcomb Oil Co	Fuel	5140429 · Fuel & Oil	8,310.03
Patrons Home Center	Ballasts, bulbs, battery clamp	5140334 · Building maintenance	120.66
Patrons Home Center	Custodial supplies	5140411 · Custodial supplies	46.50
Patrons Home Center	Sq 33	5140443 · Vehicle Parts	53.39
QuadMed Inc	Medical supplies	5140550 · Medical supplies & Materials	454.55
Sam's Club	Kitchen supplies	5140411 · Custodial supplies	199.94
Sam's Club	Printer ink, batteries, toner	5140445 · Office Supplies	196.83
Shred-It USA	File destruction service	5140445 · Office Supplies	59.10
Vidacare	IV equipment	5140550 · Medical supplies & Materials	239.89
Total 09 Ambulance Fund			<u>13,024.47</u>
SUBTOTAL - GENERAL FUND BILLS			\$ 80,558.54
13 Solid Waste Fund			
Central Indiana Truck	14 Rear Load Containers	5215717 · SW Equipment	\$ 11,374.80
Galeton	Safety vests	5215594 · Crew Safety Equipment	148.88
Keystops	Fuel	5215429 · Fuel & Lubricants	15,594.93
Lasco	Air brake antifreeze, starting fluid	5215427 · Garage supplies	199.20
Lasco	Truck 412	5215443 · Parts	528.63
Patrons Home Center	Heating cables, adhesive, dust masks, sealant	5215443 · Parts	157.14
Republic Diesel	Truck 410; wiring kit, filters	5215443 · Parts	1,116.85
Salt River	Garbage billing services I213	5215320 · Collection Contracts	9,464.28
Salt River	7522 delinquent acct's rebilled 3rdQ	5215320 · Collection Contracts	3,384.90
Springfield Laundry	Uniforms	5215481 · Employee uniforms	473.00
Total 13 Solid Waste Fund			<u>42,442.61</u>
15 Landfill Fund			
American Tire	CAT Backhoe	5210479 · Tires	326.25
AmeriGas	Propane	5210578 · Utilities	1,021.10
Cintas First Aid & Safety	First aid supplies	5210594 · Crew Safety Equipment	536.40
Duplicator Sales & Service Inc	Monthly copy charges	5210445 · Office Expense	21.96
Keystops	Fuel	5210429 · Fuel & Lubricants	8,193.85
Ky Div Waste Management	Quarterly ice	5210314 · Environmental Remediation Fee	23,385.25
Lasco	Truck 304	5210336 · Equipment Repairs	1,512.00
Lasco	Mechanic truck, Truck 304	5210443 · Parts	2,159.75
McCoy & McCoy	Monitoring	5210324 · Environmental Monitoring	10.00
Patrons Home Center	Quick links, lug nuts	5210443 · Parts	26.59
Patrons Home Center	Aerator pump repair	5210571 · Landfill Repairs	23.67
Republic Diesel	Trucks 303 and 402	5210443 · Parts	1,223.80
Springfield Laundry	Cleaning supplies	5210427 · Main supplies	128.75
Springfield Laundry	Uniforms	5210481 · Uniforms	351.50
Washington Co Fiscal Court	SW permit	5210551 · Dues & Memberships	25.00
Whyane Supply	Dozer, compactor	5210443 · Parts	160.62
Total 15 Landfill Fund			<u>39,106.49</u>
23 Occupational Tax Fund			
BNC Air	Support: July - December 2013	6201507 · Air Board Contribution	2,400.00
Danville Office	Binder, binder clips, highlighters	5047445 · OLF Office supplies	24.15
Total 23 Occupational Tax Fund			<u>2,424.15</u>
97 PIC			
Cedar Creek Quarry LLC	Radio Tower Project	8011703 · Radio Tower	450.90
Horizon Engineering	Amended plat - Lot 16D	8011703 · Radio Tower	730.00
Patrons Home Center	Custodial supplies	5082411 · SOB Custodial Supplies	172.21
Springfield Laundry	Mats	5082411 · SOB Custodial Supplies	45.00
Total 97 PIC			<u>1,398.11</u>
SUBTOTAL - PIC FUND BILLS			\$ 85,371.36
TOTAL - ALL BILLS			\$ 165,929.90

Fiscal Court Orders

Jan. 21, 2014
REGULAR SESSION OF NELSON FISCAL COURT

Book 37
Page 166

**NELSON COUNTY FISCAL COURT
PAID BILLS/TRANSFERS FOR COURT APPROVAL
January 21, 2014**

Fund/Vendor	Description	Account	Amount
<u>General Fund</u>			
BP Gas	Fuel	5105429 · Law Enforcement Fuel	\$ 5,001.80
Rogers, Justin	Contract labor	5105571 · Law Enforc. Building Repairs	522.00
<u>Landfill Fund</u>			
Rogers, Justin	Contract labor	5217161 · Recycling Contract Labor	192.00

TOTAL PAID BILLS AND TRANSFERS

\$ 5,715.80

**Nelson County Fiscal Court
Additional Bills for Court Approval
January 21, 2014**

Name	Memo	Account	Amount
01 General Fund			
SecureNet	Security system - Humane Society (Jan/Feb)	5205329 · Animal Control Maint Contracts	\$ 79.90
Total 01 General Fund			79.90
03 Jail Fund			
USPS	Postage inventory	5101428 · Canteen Inventory	1,150.00
Total 03 Jail Fund			1,150.00
97 PIC Fund			
Salt River RECC	Principal - NCIP Note	7500 603 012 · NCIP/Salt River Principal	158,158.77
Salt River RECC	Interest - NCIP Note	7500 607 012 · NCIP/Salt River Interest	45,767.04
Total 97 PIC Fund			203,925.81

Total Additional Bills

\$ 205,155.71

*** *****

NELSON COUNTY BOARD OF ADJUSTMENT

On motion of Keith Metcalfe, second of Sam Hutchins, by unanimous vote of the Court, IT IS HEREBY ORDERED to approve the appointment of Thomas Walker to the Nelson County Board of Adjustment:

NELSON COUNTY FISCAL COURT

ORDER

Pursuant to the relative Kentucky Revised Statues, **Thomas L.**

Walker is hereby appointed to the **Nelson County Board of Adjustment**

for a term in accordance to the Bylaws or governing Regulations in place.

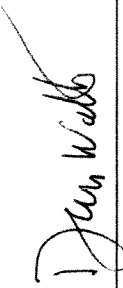

Dean Watts
Nelson County Judge Executive

1/21/14
Date

Fiscal Court Orders

Jan. 21, 2014
REGULAR SESSION OF NELSON FSICAL COURT

Book 37
Page 167

DEVELOPMENT REVIEW - DRB-203 INTEGRITY TOOL & MOLD

January 15, 2014

Via Hand Delivery

Judge/Executive Dean Watts
Nelson County Fiscal Court

RE: DRB-203 Integrity Tool & Mold
6,000 sf addition

Dear Judge Watts & Magistrates:

On Tuesday, January 14, 2014, the Development Review Board met, reviewed, and recommended approval of the site, building, landscaping, and lighting plans for the above-referenced development.

Enclosed are copies of the meeting agenda and minutes, DRB application, Design Standards Review, and site, building, landscaping, and lighting plans.

If you have any questions or need additional information, please feel free to contact me.

Sincerely,

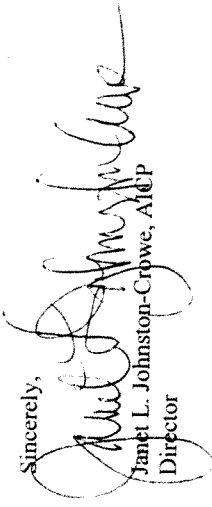

Janet L. Johnston-Crowe, AICP
Director

Enclosures

On motion of Jerry Hahn, second of Jeff Lear, by unanimous vote of the Court, IT IS HEREBY ORDERED to approve DRB-203 (Integrity Tool & Mold) as recommended.

NATIONAL SCENIC BYWAY SIGN MAINTENANCE

Judge Watts presented the following sign maintenance plan for the Lincoln Heritage National Scenic Byway which has been agreed to by Larue, Washington and Boyle Counties. A Federal grant will pay for sign construction; counties will be responsible for maintenance of signs within respective counties. On motion of Bernard Ice, second of Jeff Lear, by unanimous vote of the Court, IT IS HEREBY ORDERED to approve the following plan:

Lincoln Heritage National Scenic Byway Signage Project Maintenance Plan

The Lincoln Heritage National Scenic Byway benefits from significant historical, religious, and regional landmarks with historical downtowns linked by picturesque rural landscapes, which create a unique opportunity for visitors and residents to enjoy a variety of cultural, historical and scenic resources along the Byway.

Visitors require ease of access to their destination by use of clear communications. These needs include vehicular direction as they enter the byway, affirmation that they are heading in the correct direction, and clear direction to destinations.

Attractions and events, such as the Kentucky Bourbon Festival, has particular needs; a high volume of traffic often present during these activities creates confusion for visitors already uncertain about where they are located. Clear identification of the Lincoln Heritage National Scenic Byway is essential to helping orient a traveler. Making people aware of local cultural and historical institutions, and other area attractions adds to the value of the overall Byway experience.

This signage project will enhance the experience of visitors by placing 56 Trailblazing Signs, 12 Interpretive Panels, and 4 Gateway Signs along the Lincoln Heritage National Scenic Byway corridor. The following is a breakdown by county:

Fiscal Court Orders

Larue County

- 1 Gateway Sign near Hodgenville
- 3 Interpretive Panels
- 14 Trailblazing Signs

Nelson County

- 1 Gateway Sign near Bardstown
- 3 Interpretive Panels
- 14 Trailblazing Signs

Washington County

- 1 Gateway Sign near Springfield
- 3 Interpretive Panels
- 14 Trailblazing Signs

Boyle County

- 1 Gateway Sign near Danville
- 3 Interpretive Panels
- 14 Trailblazing Signs

The county governments of Larue, Nelson, Washington, and Boyle Counties will be responsible for maintaining the Lincoln Heritage Scenic Byway signage in their respective county. The signs will be inspected on an annual basis to determine needs for sign replacement due to damage, weathering, or other conditions. The signs will also be repaired or replaced when damaged due to being vandalized, being hit by a vehicle, or other circumstances.

Examples of each type of sign are attached to this maintenance plan.

Each jurisdiction hereby agrees to maintain the Lincoln Heritage Scenic Byways signs that will be placed in their respective county:

Tommy Turner
Larue County Judge/Executive

Dean Watts
Nelson County Judge/Executive

John Settles
Washington County Judge/Executive

Harold McKinney
Boyle County Judge/Executive

JOINT ORDINANCE – HUMAN RIGHTS

Judge Watts presented Court members with the Joint Bardstown/Nelson County Human Rights Ordinance adopted in 1986; copy given to magistrate includes original language and suggested corrections/changes. Questions from Court members related to reasons for need for change after these many years, asking the number of incidents that have occurred which would warrant a need for change to the ordinance.

(Pictures, description, dimensions of signs were included with plan)

Fiscal Court Orders

Jan. 21, 2014
REGULAR SESSION OF NELSON FISCAL COURT

Book 37
Page 169

DEPARTMENT REPORTS

**EMS - Joe Prewitt presented a comparison of purchase of a new chassis (\$85,000-\$95,000) to repowering/refurbishing a currently owned F150 (approx. \$35,000). On motion of Jerry Hahn, second of Keith Metcalfe, by unanimous vote of the Court, IT IS HEREBY ORDERED to authorize that Joe Prewitt advertise for repowering the truck as described; this would make budgeted funds available for possible use in replacing other needed equipment.

**JAIL - Jailer Dorcas Figg presented her regular report:

JANUARY	Total	NELSON COUNTY JAIL			In House	
		HIP	State	W-End		
Wed 08	123	0	3	24	4	116
Thur 09	130	0	3	24	4	123
Fr. 10	132	0	3	24	2	127
Sat. 11	121	0	3	24	2	116
Sun. 12	121	0	2	23	4	115
Mon. 13	125	0	2	22	5	118
Tue. 14	127	0	2	22	5	120
Wed 15	123	0	2	24	5	116
Thur 16	126	0	2	24	5	119
Fr. 17	123	0	2	24	5	116
Sat. 18	122	0	2	26	2	118
Sun. 19	125	0	2	26	2	121
Mon. 20	119	0	2	26	2	115
Tue. 21	119	0	2	26	2	115

DECEMBER 2013 DAILY AVERAGE	
Maindays	575
Average	18
CD	250
NELSON	2737
TOTAL	3562

NEW ARREST AND RELEASES F/DECEMBER 2013	
ARRIVALS	MALE 123 FEMALE 41 TOTAL 164
RELEASES	MALE 123 FEMALE 38 TOTAL 161

SENTENCED INMATES	
DISTRICT COURT	12
WEEKENDS	2
WAITING COURT	14
HIP	1
WORK RELEASE	1
C/S	2
STATE SENTENCED	
CI	14
CD	12
CI SERVING WEEKENDS	0
COMMUNITY SERVICE	7
HIP	1
WORK RELEASE	0
CIRCUIT WAITING COURT	62
DRUG COURT	1

TOTAL OF 76 HAS NOT BEEN SENTENCED	
DAYS	INMATES
1	67
2	37
3	14
4	10
5	11
6	8
7	5
8	7
9	1
10	4
11	6
12	9
13	6
14	3
15	4

NUMBER OF DAYS INMATES SERVED F/DECEMBER 2013	
DAYS	DAYS
1	16
2	17
3	18
4	18
5	19
6	20
7	21
8	22
9	23
10	24
11	25
12	26
13	27
14	28
15	29
	30
	31

**ROAD DEPARTMENT - Jim Lemieux reported on on-going Road Department work, including boom mowing, landfill work, salt, and pothole repair and work on various roads, as well as on road work due to snow events. He also told Court members that work has been scheduled for installation of the smoke vacuum system at the jail, although this is uncertain due to frigid weather.

**LANDFILL/SOLID WASTE - Brad Spalding reported 1) that landfill is on regular schedule this week (worked on MLK Day); 2) that highlift repair should be complete next week, but included replacement of a seal that was not initially included in price estimate; and 3) detailed drawings of the proposed landfill shop are nearing completion.

SHERIFF'S BUDGET, ORDER SETTING FEES FOR DEPUTIES/ASSISTANTS, ADVANCEMENT

Sheriff's documents for 2014 were approved on motion of Bernard Ice, second of Jeff Lear, and by affirmative vote of all Court members:

Fiscal Court Orders

Jan. 21, 2014
REGULAR SESSION OF NELSON FISCAL COURT

Book 37
Page 170

Form For Budget, Cumulative Quarterly Report and Annual Settlement For Calendar Year 2014
NELSON County Sheriff

Part One - Summary and Reconciliation of All Accounts

Show & Describe All Accounts	Column 1 2014 Fee Account Budget Estimate	Column 2 2014 Fee Account Cumulative Actual	Column 3 Account (NOT FEE ACCOUNT)	Column 4 Account (NOT FEE ACCOUNT)	Column 5 Account (NOT FEE ACCOUNT)
1. Receipts YTD	\$1,717,289.00				
2. Total Disbursements YTD	\$1,717,289.00				
3. Book Balance/Excess Fees					
4. Bank Statement Balance					
5. Plus Deposits in Transit					
6. Less Outstanding Checks					
7. Other					
8. Reconciled Bank Balance					
9. Accounts Receivable as of 12/31					
10. Unpaid Obligations as of 12/31					
11. Excess Fees					

Approved by the fiscal court on the 21 day of January, 2014.
Jerry Walsh
County Judge/Executive Date 1/21/14

To the best of my knowledge the information reported herein for the budget quarter ended DECEMBER 31, 2014 is accurate and complete.
Stephen S. Cooney
Signature of County Sheriff Date 1-13-2014

LF 1132.001 Rev 10/09

Part Two Receipts	Budget Estimate
1. Federal Grants	
2. State Grants	\$20,500.00
3. State - KLEFFP	\$97,089.00
4. State Fees/Claim	\$115,500.00
5. Circuit Clerk	
6. Sheriff Security Services	\$50,000.00
7. Fines/Fees Collected	\$50,000.00
8. Court Ordered Payments	\$0.00
9. Fiscal Court (includes Election Comm.)	\$13,000.00
10. County Clerk (Relinquish taxes)	\$37,900.00
11. Commissions on Taxes Collected	\$890,000.00
12. Fees Collected for Services	\$11,000.00
13. Auto Inspections	\$1,300.00
14. Accident/Police Reports	\$90,000.00
15. Serving Papers	\$15,000.00
16. CCDW	\$4,670.00
17. Other (describe)	\$20,750.00
18. Transport Prisoners/Patients	\$600.00
19. Interest Earned	
20. Total Revenues	\$1,417,289.00
21. Petty Cash	
22. Borrowed Money	
23. State Advancement	\$300,000.00
24. Bank Note	
25. Total Receipts (Total lines 22 through 26)	\$1,717,289.00

Copy the figures shown on line 27 in the page 1, line 9.

LF 1132.001 Rev 10/09

Part Three Disbursements	Budget Estimate	1/1 thru 3/31
Official Expenses		
1. Personal Services		
2. Sheriff's Gross Salary	\$92,475.00	
3. Deputies' Gross Salaries	\$544,157.00	
4. Part Time Gross Salaries	\$30,000.00	
5. Other Gross Salaries	\$180,702.00	
6. Overtime Gross	\$45,000.00	
7. KLEFFP Pay	\$59,604.00	
8. Employee Benefits		
9. Employer's Share Social Security		
10. Employer's Share Retirement	\$25,000.00	
11. Employer's Share Haz. Duty Ret.	\$27,424.00	
12. Employer's Workmans Compensation		
13. Employer's Unemployment Ins.		
14. Employer Paid Health Ins.	\$90,200.00	
15. Training Incentive (HB810)	\$9,000.00	
16. Contract Services Tax/Software	\$45,000.00	
17. Advertising	\$2,500.00	
18. Vehicle maintenance and repairs	\$20,500.00	
19. Office Equip. & Radio Maint.	\$15,500.00	
20. Supplies and Materials (nongable items with limited lifespan)		
21. Office Materials and supplies	\$12,500.00	
22. Uniforms	\$6,500.00	
23. Gasoline	\$50,000.00	
24. Police Equip./Supplies	\$20,727.00	
25. Public Relations Materials	\$1,500.00	
26. Juror Expenses	\$1,000.00	
27. Other Charges (non-contractual services, nongable items)		
28. Conviction / Training	\$10,000.00	
29. Dues	\$5,500.00	
30. Postage	\$18,500.00	
31.		
32.		
33. Transport Prisoners/Patients	\$15,000.00	

Sheriff's Budget and Report

Sheriff's Budget and Report

Fiscal Court Orders

Jan. 21, 2014
REGULAR SESSION OF NELSON FISCAL COURT

Book 37
Page 171

Part Three Disbursements	Budget Estimate	1/1 thru 3/31
34. Auto Expenses on Personal Vehicles		
35. Gasoline		
36. Maintenance and repairs		
37. Re: Insurance		
38. Depreciation		
39.		
40. Debt Service (borrowed money, interest, lease purchases)		
41. State Advancement	\$300,000.00	
42. Notes		
43. Interest		
44.		
45. Capital Outlay (straight purchases of tangible items lasting in nature)		
46. Office Equipment		
47. Vehicles	\$81,000.00	
48.		
49. Misc. / Emergency Funds	\$10,000.00	
50. Total Official Expenses	\$1,717,289.00	
For offices that fee pool, pay fees to county prior to December 31, or counties over 70,000 in population, show payment		
51. Payments to County Treasurer		
52. Payments to State Treasurer		
53. Total Disbursements (Total lines 50, 51, and 52)	\$1,717,289.00	

Copy the figures shown on line 53 in the Budget Estimate column to the 5th

Part Four - Liabilities Outstanding

Quarter ended 2014

Multi-year Issues Where Budgeted	Issue	Issue	Totals
Description			
Term (# of Years)			
Current Interest Rate			
Issue Date			
Total Principal Amount			
Total Interest Amount			
Total Issue			
Principal Balance Remaining			
Interest Balance Remaining			
Less Reserve Earnings			
Net Outstanding			
Next Payment Date			
Next Payment Amount			
Final Payment Date			
Short Term Liabilities Where Budgeted	Issue	Issue	
Description			
Term			
Current Interest Rate			
Issue Date			
Total Principal Amount			
Total Interest Amount			
Total Issue			
Principal Balance Remaining			
Interest Balance Remaining			
Total Outstanding			
Next Payment Date			
Next Payment Amount			
Final Payment Date			
Total Outstanding Debt	(If no outstanding advancements, loans, leases, or other debt, show "0")		

Comments: The Nelson County Fiscal Court does the payroll for the Sheriff's Office. Nelson Fiscal Court pays the Social Security, retirement, and fringe benefits. The Sheriff's Office pays the health benefits to Nelson Fiscal Court.

On line 11, part 2, are County claims as follows; Serving Juvenile Summons, attending Fiscal Court meetings, and Transporting Prisoners.

Line 20 is different. This is for State Prisoners that have been indicted.

ANNUAL ORDER SETTING MAXIMUM AMOUNT FOR DEPUTIES AND ASSISTANTS

Pursuant to KRS 64.530(3), "...The fiscal court shall fix annually the maximum amount, including fringe benefits, which the officer may expend for deputies and assistants...."

The fiscal court of NELSON County in compliance with state law hereby sets the maximum amount which the SHERIFF of NELSON County may expend from fees during calendar year 2014 at \$942,483 for deputies, assistants and other employees. The maximum amount as set includes all amounts paid from fees for:

Fiscal Court Orders

Jan. 21, 2014

REGULAR SESSION OF NELSON FISCAL COURT

Book 37
Page 172

- ✓ Full time salaries and wages
- ✓ Overtime wages
- ✓ Part time salaries and wages
- ✓ Vacation and sick leave
- ✓ Health insurance
- ✓ Insurance other than health
- ✓ Employer match SS/Retirement

Motion made by Bernard Ice, second by Jeff Lear

Vote Bernard Ice, Jeff Lear, Jerry Hahn, Sam Hutchins and Keith Metcalfe

Signed *Keith Metcalfe* Fiscal Court Clerk

Date: 1/21/14

Stephen D. Campbell SHERIFF
NELSON COUNTY, KY
STATEMENT OF AMOUNT TO BE ADVANCED EACH MONTH
IN 2014

MONTH	ESTIMATED EXPENSES	ESTIMATED RECEIPTS	ESTIMATED ADVANCEMENT
JANUARY	80,000.00	20,000.00	60,000.00
FEBRUARY	70,000.00	50,000.00	20,000.00
MARCH	100,000.00	60,000.00	40,000.00
APRIL	70,000.00	40,000.00	30,000.00
MAY	70,000.00	50,000.00	20,000.00
JUNE	70,000.00	50,000.00	20,000.00
JULY	100,000.00	50,000.00	50,000.00
AUGUST	70,000.00	50,000.00	20,000.00
SEPTEMBER	90,000.00	60,000.00	30,000.00
OCTOBER	85,000.00	75,000.00	10,000.00
NOVEMBER	313,288.00	554,001.00	0.00
DECEMBER	599,001.00	358,288.00	0.00
TOTALS	1,717,289.00	1,417,289.00	300,000.00

I hereby certify, to the best of my knowledge, the above is a true estimate of the amount needed to be advanced each month for the operation of the county sheriff's office.

Stephen D. Campbell SHERIFF
APPROVAL MUST BE MADE BY FISCAL COURT NELSON COUNTY
APPROVED THIS _____ DAY OF _____, 2014.

Jeff Lear COUNTY JUDGE/EXECUTIVE

LEASE AGREEMENT - SALT RIVER ELECTRIC

On motion of Keith Metcalfe, second of Jeff Lear, by unanimous vote of the Court, IT IS HEREBY ORDERED to authorize County Judge-Executive to sign the following lease agreement between Salt River RECC and the County of Nelson (communications tower):

Fiscal Court Orders

THIS LEASE AGREEMENT, made and entered into this 9th day of January, 2014, by and between Salt River Electric, 111 W. Brashear Avenue, Bardstown, Kentucky 40004, hereinafter designated LESSOR, and

Nelson County Fiscal Court, a governmental body located in the county of Nelson, State of Kentucky, One Court Square, Bardstown, Kentucky, 40004, hereinafter designated LESSEE.

WITNESSETH:

Lessor does hereby let and lease unto the Lessee under the terms, conditions and duration set out below, the following described property, to-wit:

A certain tract of land located off of Parkway Drive, in Bardstown, Nelson County, Kentucky on which a communication tower shall be constructed, specifically including all areas necessary for the communication tower itself, all supporting structures, guy wires, equipment, an equipment building, fencing, utilities and an easement for ingress and egress over the balance of the Lessor's property to access the site and all supporting areas. The area leased is more particularly described in the attached exhibit A which is incorporated by this reference and is over two larger parcels of land owned by Lessor more particularly described as follows:

Tract 1:

Being part of Tract 1, consisting of 43.106 acres, as depicted upon the Plat of the Boundary Survey for C. Barr Schuler Trust & JoAn Brown Schuler Trust, of record in Plat Cabint 14, Slot 70 in the Office of the Clerk of Nelson County, Kentucky.

Being a portion of the same property to which Salt River Electric Cooperative Corporation acquired title from First Bankers Trust Company, Trustee by deed dated November 19, 2010 of record in Deed Book 472, page 390 in the Office of the Clerk of Nelson County, Kentucky.

Tract 1A

Being part of Tract 1A, consisting of 33.00 acres, as depicted upon the Plat of the Agricultural Division for C. Barr & JoAn Brown Schuler, of record in Plat Cabinet 13, Slot 103, in the Office of the Clerk of Nelson County, Kentucky.

Being a portion of the same property to which Salt River Electric Cooperative Corporation acquired title from First Bankers Trust Company, Trustee by deed dated July 8, 2009 of record in Deed Book 461, page 63 in the Office of the Clerk of Nelson County, Kentucky.

Said Property may be used for Lessor's use so long as the activities do not harm or could cause future harm to the tower, supporting structures, guy wires, building and fencing.

- 1. TERM:** This lease shall be for a term of ninety nine years, beginning on the 1st day of July, 2013 and ending on the 30th day of June, 2112 or for so long as said property is used as a communication tower.
- 2. RENT:** The rent shall be \$1.00 per year for the above term, beginning on the 1st day of July 2013. The Lessee shall have the right and option to renew the lease for another ninety nine years with the rent of \$1.00 per year subject to all covenants, provisions and agreements of this lease. This agreement shall be automatically renewed unless written notice by either party not less than thirty (30) days prior to the expiration of the term of this lease. Each year's rent shall be payable on July 1 of said year.
- 3. IMPROVEMENTS:** Lessee may make alterations, additions and improvements to the leased premises at its own expense. Lessee shall remove tower, supporting structures, guy wires and concrete pads within ninety (90) days after the termination of this lease.
- 4. BINDING EFFECT:** This lease shall be binding upon the parties hereto and their heirs, assigns, successors, executors and administrators, except that no assignment of Lessor's interest shall be binding on Lessee unless Lessor shall have given Lessee written notice thereof.

Fiscal Court Orders

5. **ORDER OF PLACEMENT:** The Lessor shall be provided locations on the tower for their use and not to exceed the structural capacities of the tower or interfere with the operation of other units on the tower after placement of the Lessee's equipment. Any additions to the tower (including but not limited to other parties or replacement parties) shall be mutually agreed upon by the Lessor and Lessee.
- a. The Lessor shall have use of the tower for communication needs up to 288 feet (Mean Sea Elevation of 1,046 feet) subject to the provision that the communication frequencies do not interfere with the Lessee's frequencies. Satellite links or other devices that will not interfere with the Lessee's equipment can be installed at higher elevations than 1,046 feet provided that the communication tower can structurally withstand the new loading and any additional costs to upgrade the tower for such equipment shall be at the cost of the Lessor.

This Lease Agreement consisting of this and one preceding pages, contains the entire agreement between the parties hereto and is executed by the respective officers of the parties hereto, and on their behalf all pursuant to the authority granted by the respective governing bodies.

IN WITNESS WHEREOF, the parties have hereunto subscribed their names on the day and year first above written.

Salt River Electric Authorized Representative

Nelson County Fiscal Court

BY:

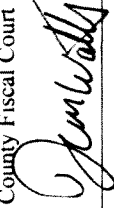

Commonwealth of Kentucky
County of Nelson

I, a Notary Public, in and for the state and county aforesaid do hereby certify that the foregoing instrument was produced before me in said county and acknowledged and sworn by Salt River Electric Representative, and executed this instrument as their free act and deed and that they are known to me, or if not known to me, presented satisfactory evidence to me that they are the persons described in and who executed the instrument. Given under my hand this 9th day of January, 2014.

My Commission expires: 3/21/15.

Notary Public

Commonwealth of Kentucky
County of Nelson

I, a Notary Public, in and for the state and county aforesaid do hereby certify that the foregoing instrument was produced before me in said county and acknowledged and sworn by BJE DEAN WATTS, for an on behalf of Nelson County Fiscal Court, and executed this instrument as his free act and deed and that he is known to me, or if not known to me, presented satisfactory evidence to me that he is the person described in and who executed the instrument. Given under my hand this 21 day of JANUARY, 2014.

My Commission expires: 10-4-2017

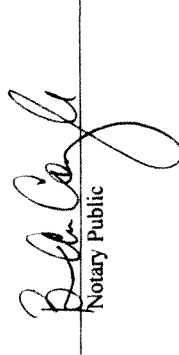
Notary Public

This document was prepared by:

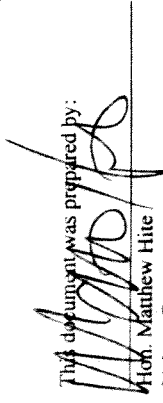
Hon. Matthew Hite
Nelson County Attorney
202 E. Stephen Foster Ave.
Bardstown, KY 40004
502-348-1850

RESOLUTION

Larry Hicks be and is hereby authorized to execute the communications tower

lease between Salt River and Nelson County.

Secretary:

Linda West



Jimmy Longmire

Fiscal Court Orders

Jan. 21, 2014

REGULAR SESSION OF NELSON FISCAL COURT

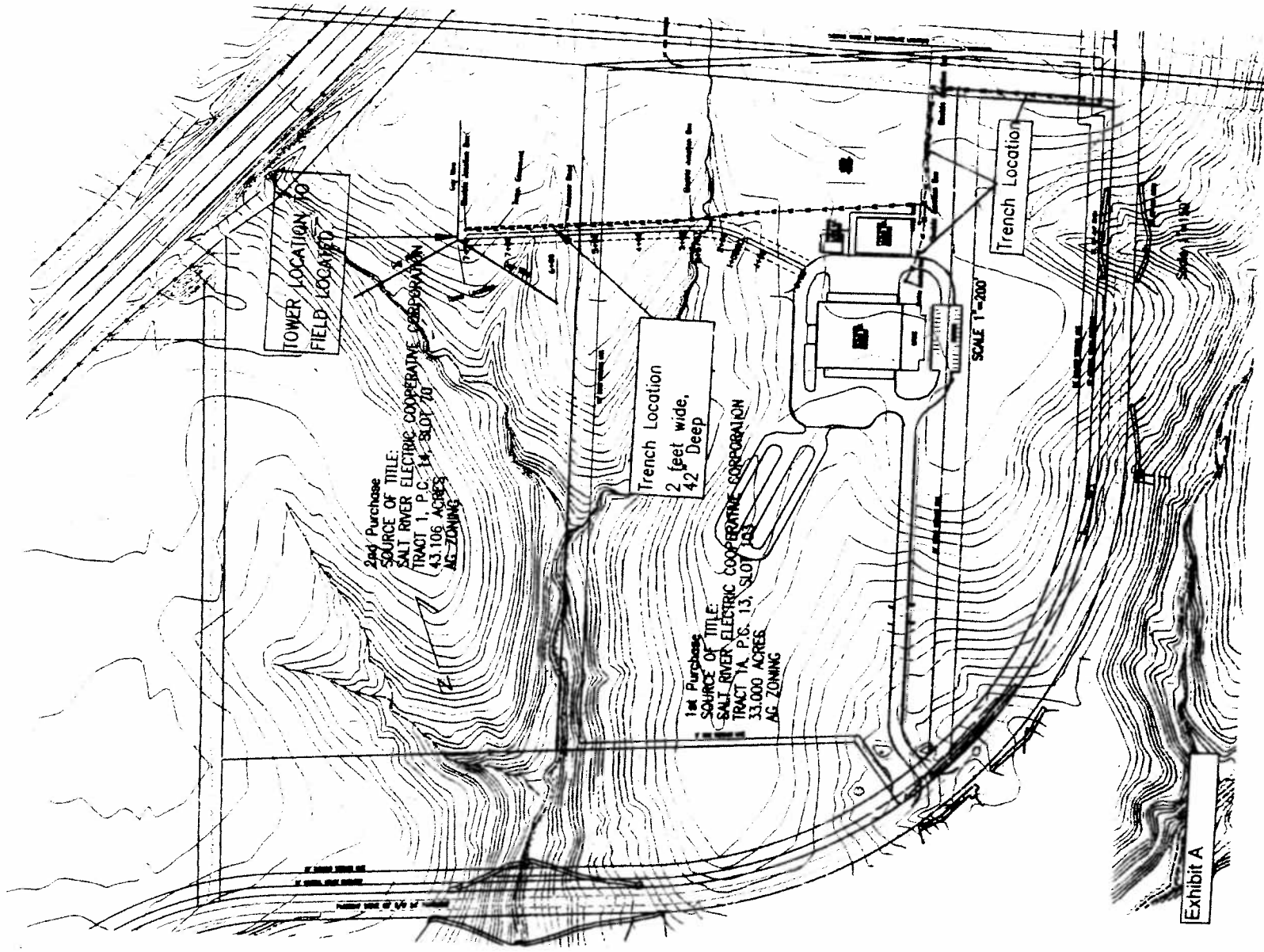
Book 37
Page 175



On motion of Bernard Ice, second of Jerry Hahn, by unanimous vote of the Court, IT IS HEREBY ORDERED to adjourn the Jan. 17 session of Nelson Fiscal Court.

DEAN WATTS, NELSON COUNTY JUDGE-EXECUTIVE

ELAINE A FILLATREAU, NELSON COUNTY CLERK

Fiscal Court Orders

